



GOLDSTRIKE™ ROTOR COVERS



INSTALLATION INSTRUCTIONS:

| | | |
|-----------------|---|------------------|
| Parts Included: | 1 | RIGHT LIGHT RING |
| | 1 | RIGHT STRUCTURE |
| | 1 | LEFT LIGHT RING |
| | 1 | LEFT STRUCTURE |
| | 1 | HARDWARE KIT |

Park on a level surface and shut off the motorcycle. Ensure the engine has time to cool before installation.

Note: Work on one side of motorcycle and complete the installation before moving on to the other side.

1. Remove fender. 2 screws on each side. (Fig.1)
2. Remove the two 10mm axle pinch bolts. (Fig.1)
3. Remove side covers. Open the saddle bags and remove side covers by pulling away from the motorcycle with steady pressure.
4. Remove seat. Remove the socket head screws under the front of the seat. Pull up on the front of the seat and slide it forward. Unplug the connector for the heated seat under the right side cover.

NOTE: Set the removed parts and hardware aside for re-installation.

5. Remove the fuse box cover. Attach the +(red) and -(black) wire leads to the screws at the top left area of the fuse panel. Plug in the right and left lights rings to test and understand the functions. Unplug the lights and set them aside. (Fig.3)
6. For run and turn function, plug the connectors into the corresponding sides of the of the Goldstrike 48000 harness (sold separately) Plug in the right and left lights rings to test and understand the functions. Unplug the lights and set them aside.



Fig.1



Fig.2



Fig.3

WARNING:

This indication alerts you to the fact that ignoring the contents described herein can result in potential serious injury or death if not followed.

CAUTION:

This indication alerts you to the fact that ignoring the contents described herein can or will result in material damage and/or personal injury.

ATTENTION:

This indication alerts you to the fact if you ignore this detail you will affect the performance or functionality of the product.

All Giro products are designed for "easy assembly" and/or "plug and play". We recommend a competent mechanic install our products, using standard mechanical procedures to assure a safe and successful installation.

NOTE:

Giro products are designed and manufactured under very strict quality control. Giro warrants that products sold to the original purchaser shall be free from any defects in materials and workmanship for a period of 3 (three) years from the date of purchase, and a lifetime warranty against LED failure.

Giro will have no obligation if the customer cannot show proof of purchase. Warranty will not be granted unless the part is properly installed and maintained. Giro will not be liable for any consequential and incidental damages, including labor, or non-Giro products. Please visit our website Ciro3d.com for our complete warranty policy.

7. Install right bracket (pic) as shown starting with the inside 10mm bolt first. Then install the second (outer) bolt. Hand tighten both bolts making sure the bracket stays parallel to the brake rotor. (Fig 4.)
8. Tighten the bolts, alternating between them to ensure even clamp load.
9. Torque the 10mm axle pinch bolts to the factory specification: **22 N-m, 16 lbf-ft**

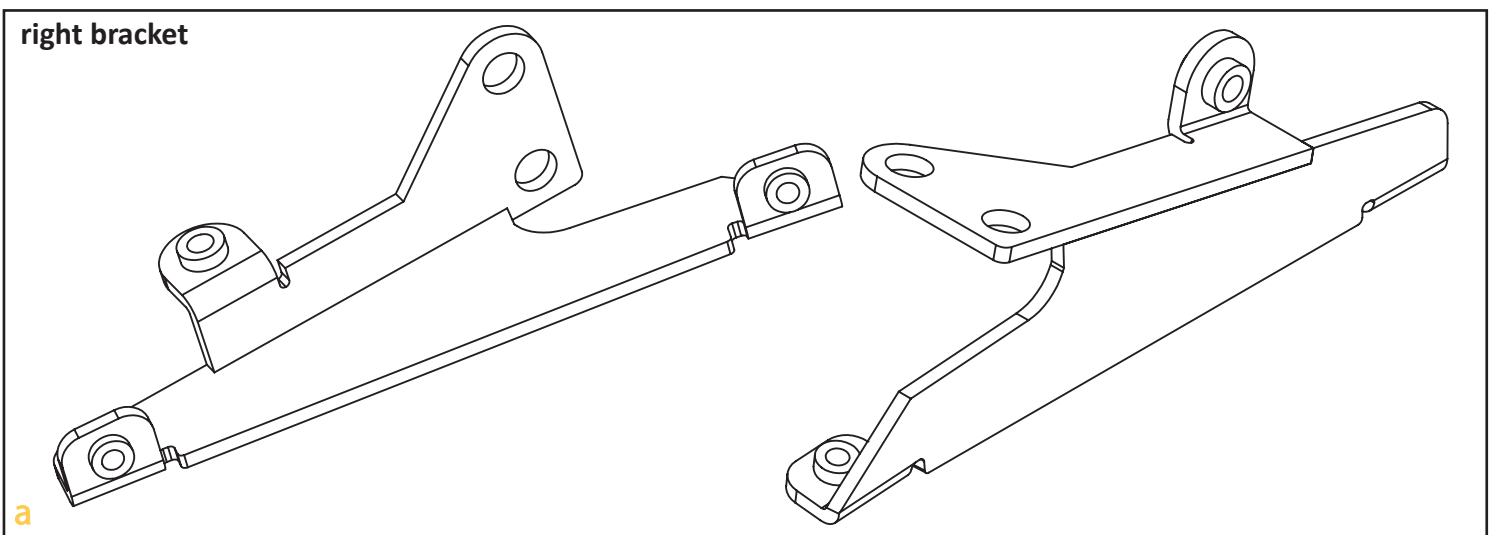
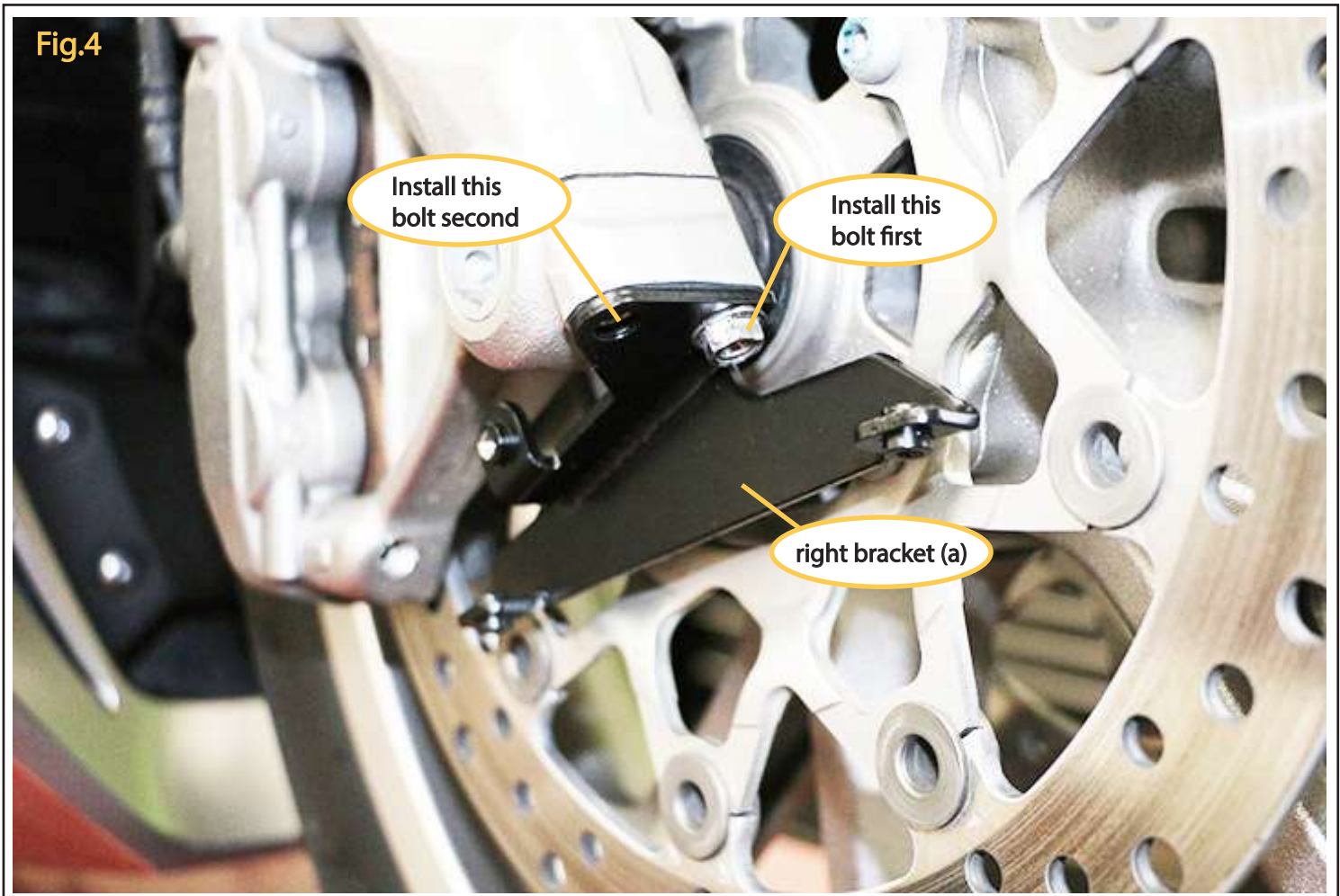

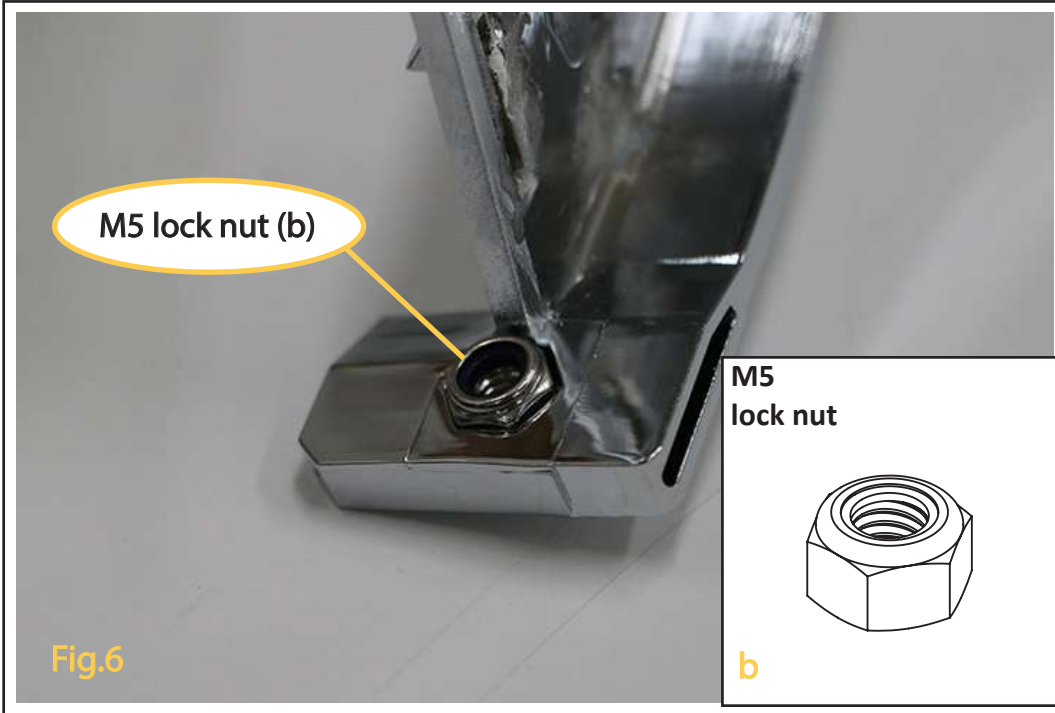

10. Install the "L" shaped bracket using the M5 x 16 button head screw and M5 lock nut as shown in (Fig.6) and (Fig.7)

11. Install the assembly by placing the "L" bracket onto the lower fender mounting hole.

The bracket mounts to the aluminum fork leg under the black inner fender. (Fig.8)

ATTENTION: Check position of all components and fully tighten all hardware. 5mm screws: 5.2 N-m, 3.8 lbf-ft

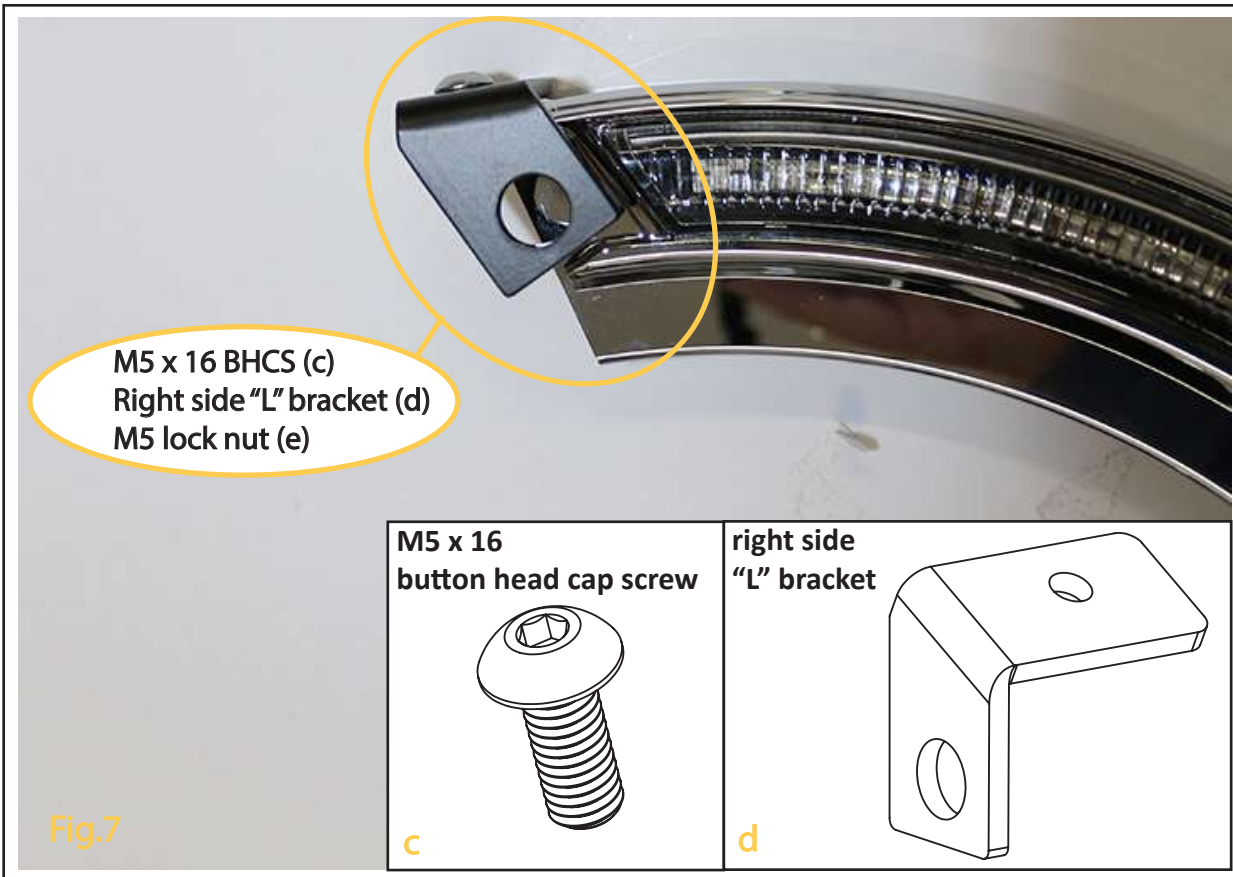

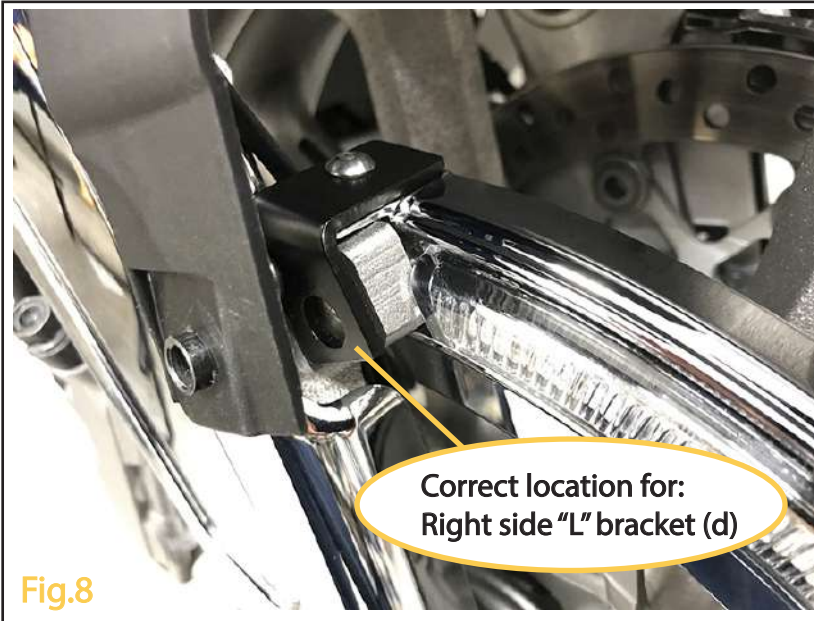

12. Align the two lower holes to the bracket and install the flange head screws. (Fig.9)

13. Check adjustment to be sure the cover is clear of the rotor, then tighten the screws. (Fig.9)

ATTENTION: Check position of all components and fully tighten all hardware. 5mm screws: 5.2 N-m, 3.8 lbf-ft

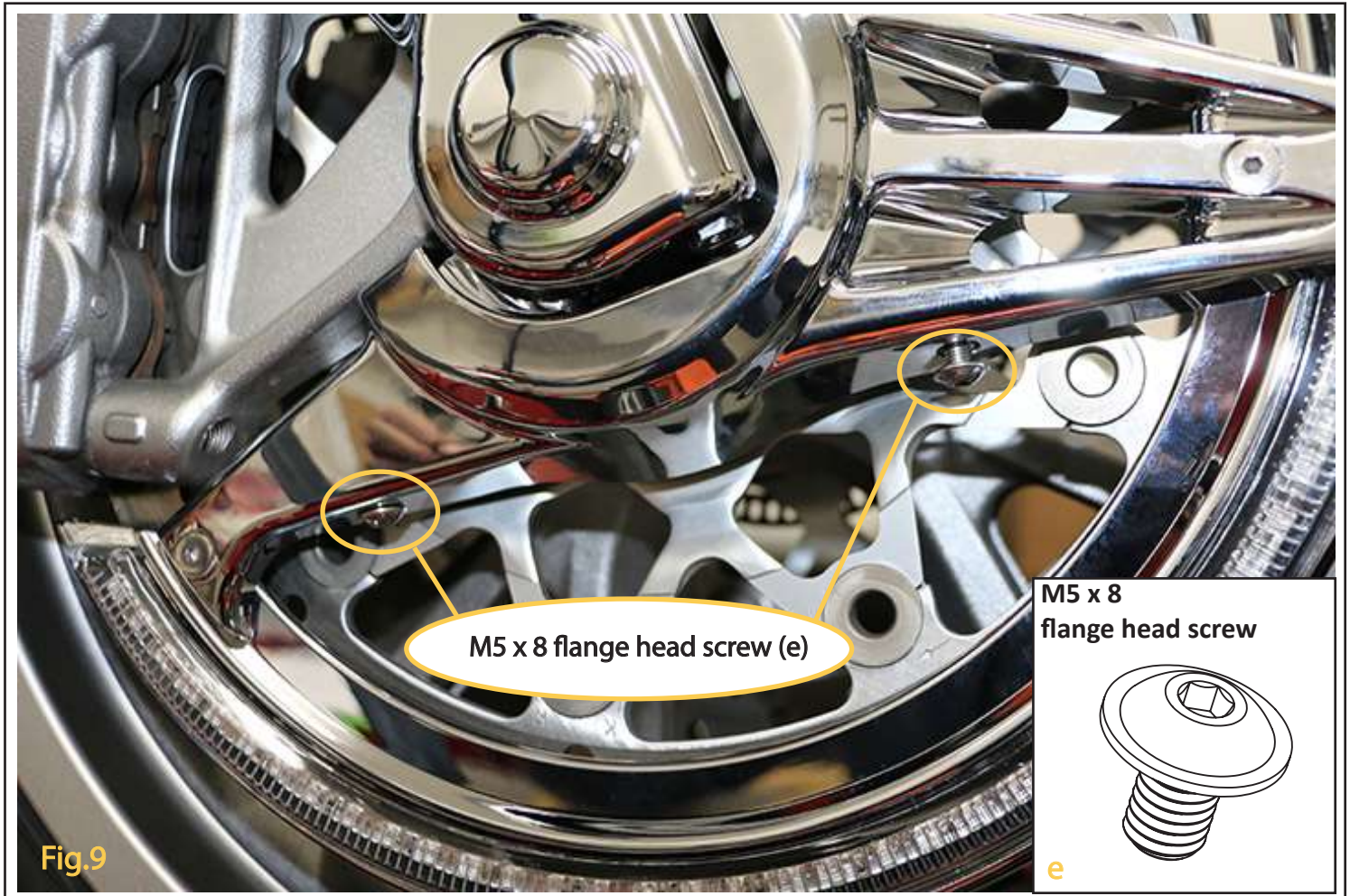

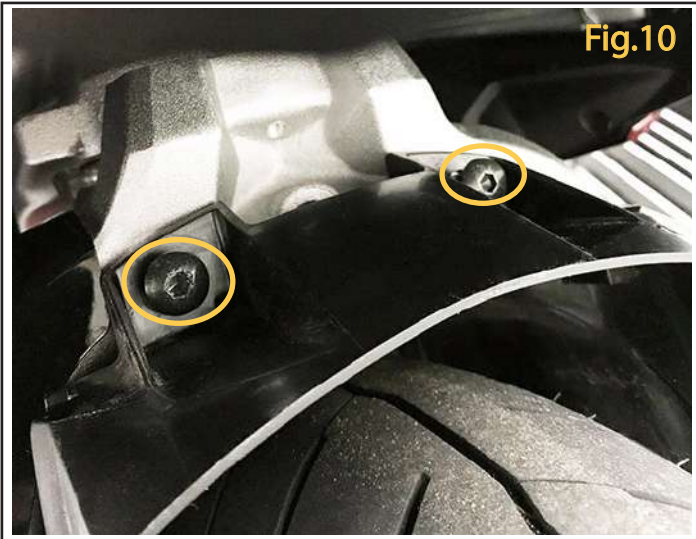

Fig.10

14. Route the wire in between the fork and black plastic inner fender. Remove the screws for additional clearance. (Fig.10)

15. Pass the wire up through the fairing and out near the handle bar. (Fig.11)

16. Use a stiff wire tool and slide it under the bodywork at the front of the seat into the gap between the fuel tank and bodywork. (Fig.12)

17. The tool will come out under the handlebar. Securely tape the wire connector to the tool and GENTLY pull the connector into the under seat area.(Fig.11)

NOTE: Removing the screws that attach the bodywork can provide additional clearance for fishing the wire if needed. (Fig.12)

Repeat steps 7-17. on the other side of the motorcycle.



Fig.11

Tool / Wire path

18. Route the plugs coming off the fuse panel up under the frame into the under seat area. Plug in the left and right connectors into the harness coming from the fuse panel. Turn on the ignition and test the lights. (Fig.13)

19. For run and turn function, plug the connectors into the corresponding sides of the of the Goldstrike 48000 harness (sold separately)

20. Check wire clearance and routing in the under seat area. Find a path that will not interfere with the seat installation.

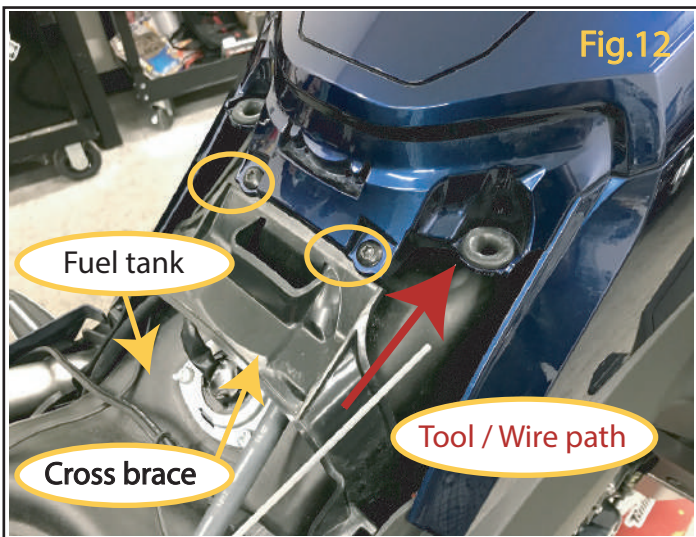

Fig.12

Fuel tank

Cross brace

Tool / Wire path



Fig.13

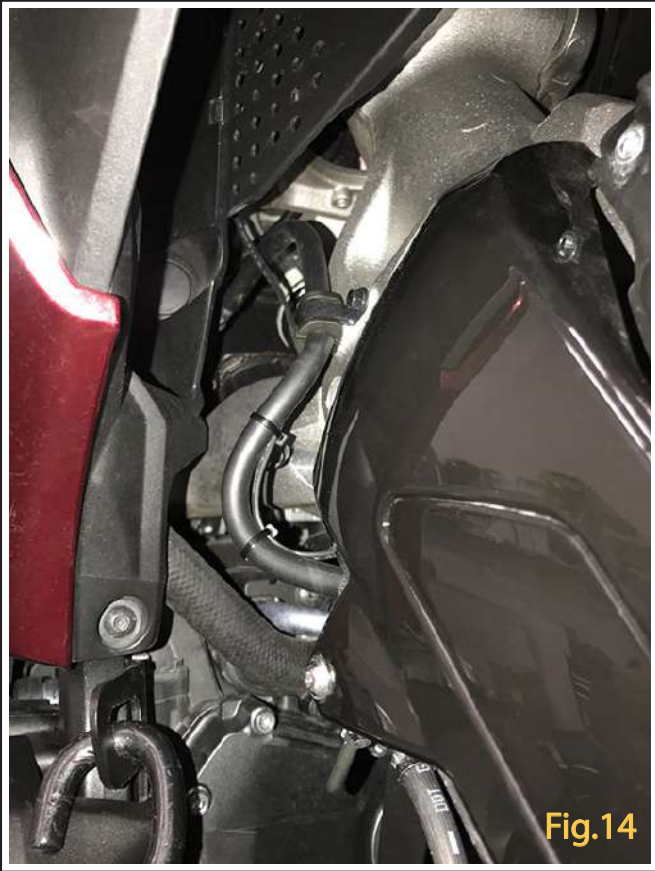

Fig.14

21. Check wire route and secure wires. Start down near the wheel and work your way up to the connectors.

ATTENTION: Proper wire routing and secure placement is the responsibility of the installer. Check all clearances, especially near moving parts of the motorcycle.

ATTENTION: Rotate the front wheel fully left to right and then bounce the front suspension up and down. Make sure that you have attached the wires securely but with enough slack to allow for steering and suspension movement.

22. Install the zip tie keeper and run the wire as shown. Apply the primer (adhesion promoter) according to the instruction on its container. (Fig.15) (Fig.16)

NOTE: It is important the wire tie downs are placed as shown, on a clean surface.

ATTENTION: Before applying the primer. Thoroughly clean the mounting surface with denatured alcohol to remove all wax, oil, and residue.

NOTE: New motorcycles are delivered from the factory covered in protective oil. Remove it before installing this product.

NOTE: Do not install if the temperature is below 50° F. The adhesive will not cure properly.

23. Route the wire along the brake line and attach it with zip ties. (Fig.14)



Fig.15

Zip Tie Keeper. (f)

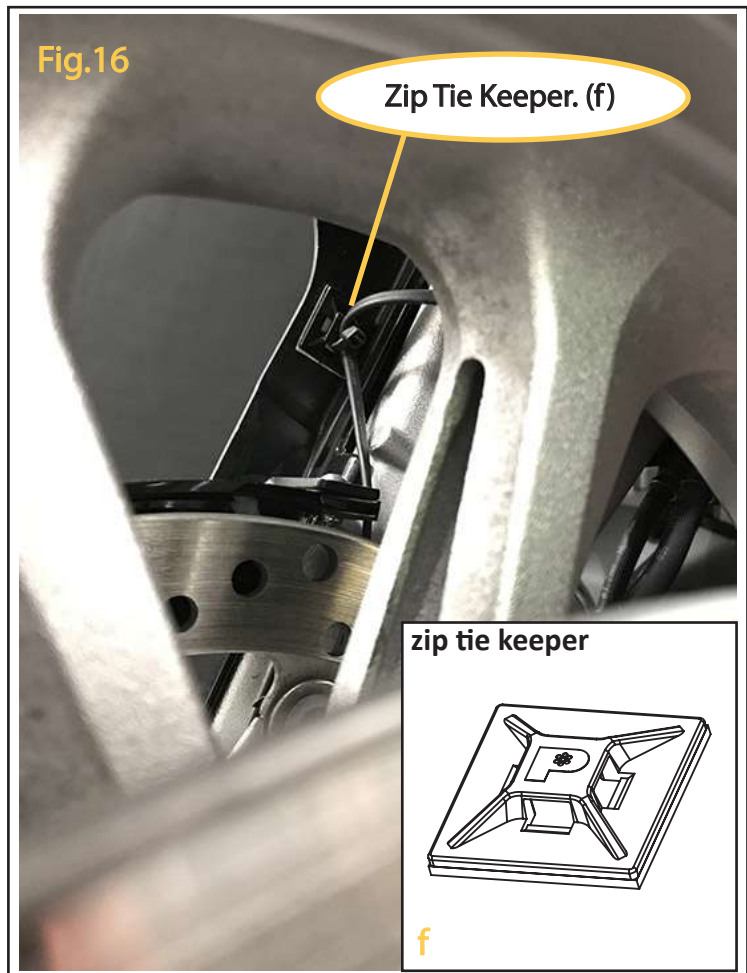
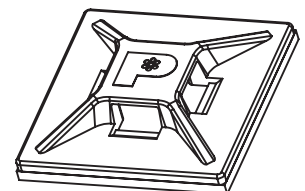

Fig.16

Zip Tie Keeper. (f)

zip tie keeper



f