

Copyright © 2019 by Big Bike Parts, Inc. No part of this instruction sheet may be reproduced without the written permission of Big Bike Parts, Inc.

PART NO. 52-954

CYLINDER HEAD COVERS

FITMENT: HONDA GOLDWING/GOLDWING TOUR 2018-NEWER

4/15/2019

TOOLS NEEDED: 5MM ALLEN WRENCH

8MM WRENCH

REMOVABLE THREAD LOCKER

PLEASE READ THROUGH AND UNDERSTAND THESE INSTRUCTIONS BEFORE BEGINNING. ESTIMATED INSTALLATION TIME: 30 TO 40 MIN.

USE REMOVABLE THREAD LOCKER ON ALL FASTENERS

INSTALLATION:

1. STARTING ON THE LEFT SIDE OF THE BIKE, USE A 5MM ALLEN WRENCH TO REMOVE THE TWO SCREWS IN FIG. 4 AND PULL FORWARD ON THE LEFT FOG LIGHT COVER TO REMOVE IT.
2. REMOVE THE SCREW HOLDING THE REAR OF THE COWL AND PULL OUT SLIGHTLY ON THE COWL TO RELEASE IT (FIG. 2).
3. REFERENCE FIG. 3 TO DETERMINE THE LEFT AND RIGHT CYLINDER HEAD COVERS. SET THE RIGHT COVER ASIDE.
4. USE AN 8MM WRENCH TO REMOVE THE TWO BOLTS SHOWN IN FIG. 4.
5. PULL THE LOWER SHELTER (FIG. 4) BACK SLIGHTLY AND SLIDE THE LEFT CYLINDER HEAD COVER IN PLACE (FIG. 5). BE SURE TOP OF THE CYLINDER HEAD COVER SITS FLUSH AS SHOWN IN FIG. 5.
6. INSTALL THE TWO BOLTS THAT WERE REMOVED IN STEP 4 WITH A FLAT WASHER SUPPLIED IN THE KIT ADDED TO EACH.
7. REPEAT STEP 1 AND 2 IN REVERSE ORDER.
8. REPEAT STEP 1 ON THE RIGHT SIDE.
9. REPEAT STEPS 4 THROUGH 7 ON THE RIGHT SIDE. (DO NOT NEED TO PULL THE LOWER SHELTER BACK ON THE RIGHT SIDE)

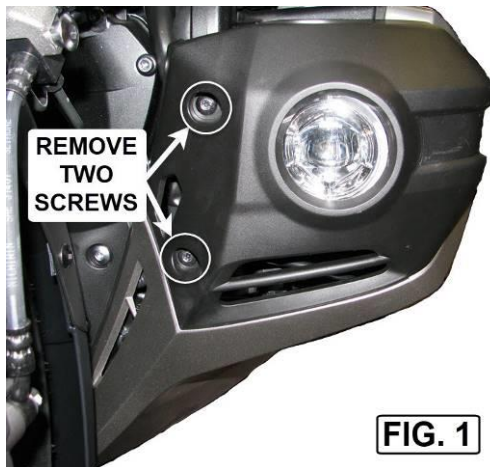

FIG. 1

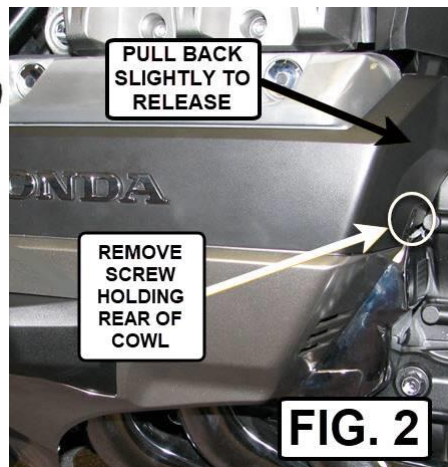

FIG. 2

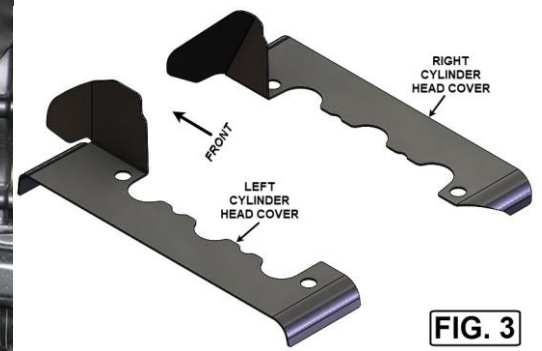

FIG. 3

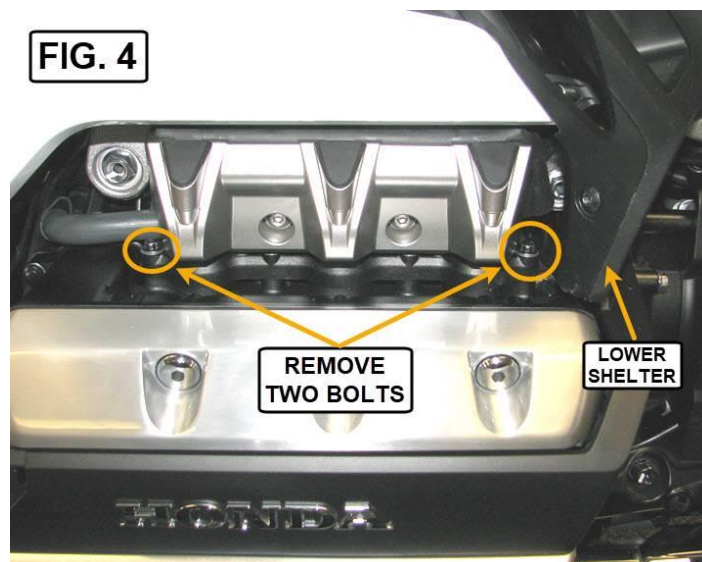

FIG. 4

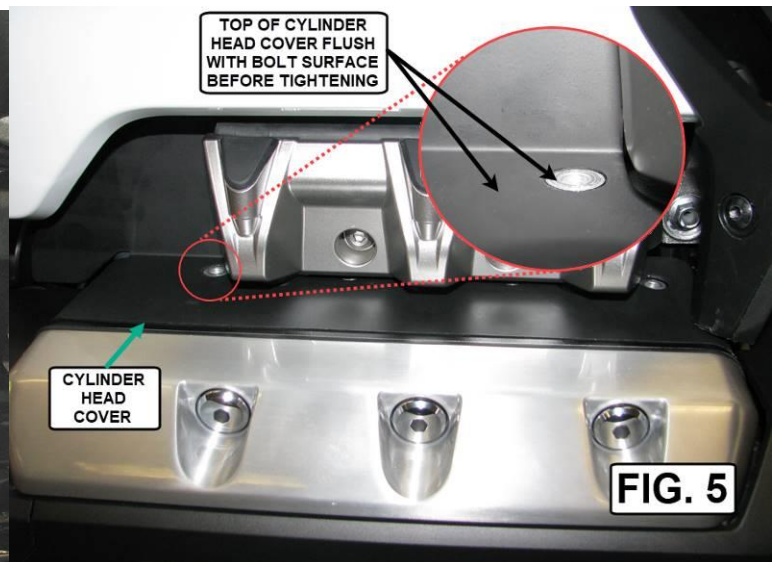

FIG. 5

NOTICE

IGNORING THE CONTENTS OF THESE INSTRUCTIONS MAY AFFECT THE PRODUCT PERFORMANCE AND FUNCTIONALITY. NOT FOLLOWING THESE INSTRUCTION MAY CAUSE DAMAGE TO THE PRODUCT OR THE VEHICLE TO WHICH IT IS BEING ATTACHED.