

INSTALLATION INSTRUCTIONS

PART NO. 52-927

GT TOUR TRUNK LIGHT

FITMENT: HONDA GOLDWING TOUR 2018-NEWER

4/9/2019

TOOLS NEEDED:	5MM ALLEN WRENCH	PHILLIPS SCREWDRIVER	MASKING TAPE	PENCIL/FINE MARKER	RUBBING ALCOHOL
	CLEAN RAG	DRILL	5/16" DRILL BIT	DUCT TAPE	

PLEASE READ THROUGH AND UNDERSTAND THESE INSTRUCTIONS BEFORE BEGINNING.

ESTIMATED INSTALLATION TIME: 60 TO 90 MIN.

NOTE: IT IS RECOMMENDED TO USE BBP PART NUMBER 52-942 ELECTRONIC FUSE BLOCK WHEN CONNECTING ACCESSORIES TO THE BIKE.

INSTALLATION:

1. WITH BOTH SADDLEBAGS OPEN, REMOVE THE SIDE PANELS BY PULLING THEM OUT STRAIGHT OUT (FIG. 1).
2. USE A 6MM ALLEN WRENCH TO REMOVE THE TWO SEAT BOLTS (FIG. 2 SHOWS LEFT SIDE).
3. DISCONNECT THE SEAT WIRE HARNESS PLUG LOCATED UNDER THE RIGHT SIDE PANEL (FIG. 3).
4. REMOVE THE SEAT BY LIFTING UP ON THE FRONT OF THE SEAT AND PULLING TOWARDS THE FRONT OF THE BIKE.
5. OPEN THE TRUNK LID AND REMOVE THE 6 PHILLIPS SCREWS SHOWN IN FIG. 4 AND ONE ON EACH SIDE LOCATED BY THE ARROWS IN FIG. 4.
6. CAREFULLY LIFT THE TRUNK BACKREST PAD AND DISCONNECT THE WIRE HARNESS TO REMOVE THE BACKREST PAD (FIG. 5).
7. REMOVE THE WIRE HARNESS AND CONNECTOR FROM THE TABS IN THE TRUNK LID (FIG. 6).
8. REMOVE THE SIX SCREWS IN FIG. 6 AND REMOVE THE TRUNK LID. (BE SURE TO SUPPORT THE TRUNK LID WHEN REMOVING THESE SCREWS)
9. PLACE TRUNK LID WITH THE INSIDE FACING UP ON A CLEAN SOFT SURFACE TO AVOID SCRATCHING.
10. REMOVE ALL THE SCREWS AND LATCHES IN FIG. 7.
11. STARTING AT THE FRONT OF THE TRUNK LID, CAREFULLY REMOVE THE LID LINER FROM THE LID BY PULLING THEM APART AT EACH SCREW LOCATION UNTIL THE TRUNK LINER POPS OUT. SET THE TRUNK LID LINER ASIDE FOR NOW.
12. TURN THE TRUNK LID OVER SO THE BACK IS FACING YOU.
13. PLACE A PIECE OF MASKING TAPE ON THE TRUNK LID AS SHOWN IN FIG. 8. MEASURE AND MARK THE TRUNK LID CENTER LINE.
14. PLACE MASKING TAPE AND MARK THE HOLE TO BE DRILLED ACCORDING TO FIG. 9.
15. DRILL A 5/16" HOLE THROUGH THE TRUNK LID CENTERED ON THE MARK.
16. REMOVE THE MASKING TAPE AND ANY BURS FROM DRILLING THE HOLE.
17. CLEAN THE OUTSIDE OF THE TRUNK LID WHERE THE LIGHT WILL BE MOUNTED WITH RUBBING ALCOHOL AND A CLEAN RAG.
18. LET THE TRUNK LID DRY COMPLETELY.
19. FEED THE END OF THE TRUNK LIGHT WIRE CABLE THROUGH THE 5/16" HOLE FROM THE OUTSIDE OF THE TRUNK AND PULL THE SLACK THROUGH.
20. REMOVE THE MASKING FROM THE TRUNK LIGHT AND CAREFULLY PRESS THE LIGHT INTO PLACE ON THE TRUNK LID (FIG. 10).
21. TURN THE TRUNK LID OVER AGAIN AND TAPE THE WIRE CABLE ALONG THE CENTER OF THE TRUNK LID AS SHOWN IN FIG. 11.
22. REPEAT STEPS 7 THROUGH 11 IN REVERSE ORDER.
23. RUN THE TRUNK LIGHT WIRE CABLE ALONG THE BACKREST PAD WIRE HARNESS AND BEHIND THE PANEL SHOWN IN FIG. 12. SECURE THE WIRE CABLE WITH THE SUPPLIED WIRE TIES AS NEEDED.
24. REPEAT STEP 5 AND 6 IN REVERSE ORDER.
25. USING FIG. 13 CONNECT EACH WIRE TO AN ELECTRONIC FUSE BLOCK (PART NUMBER 52-942) OR EQUIVALENT.
26. BLACK WIRE FOR GROUND, GREEN WIRE FOR BRAKE, YELLOW WIRE FOR LEFT TURN, BLUE WIRE FOR RUNNING, WHITE WIRE FOR RIGHT TURN.

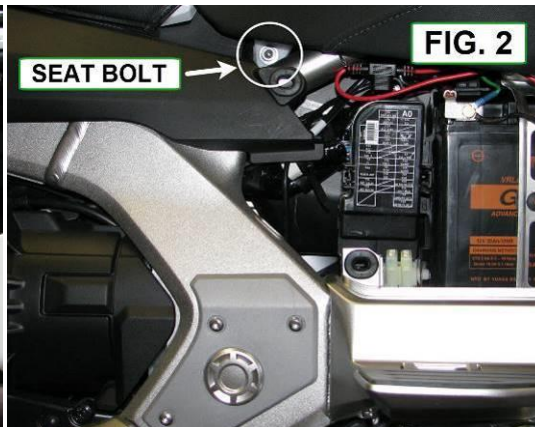
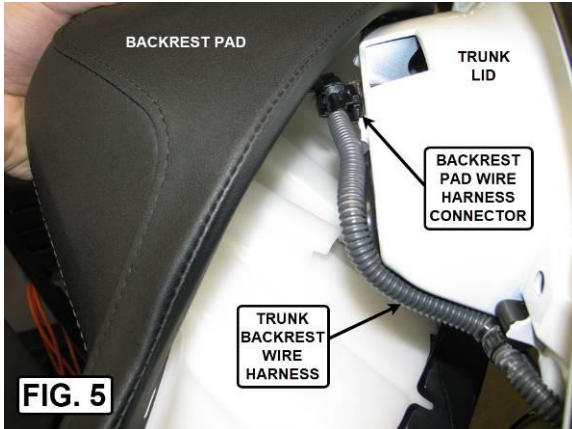
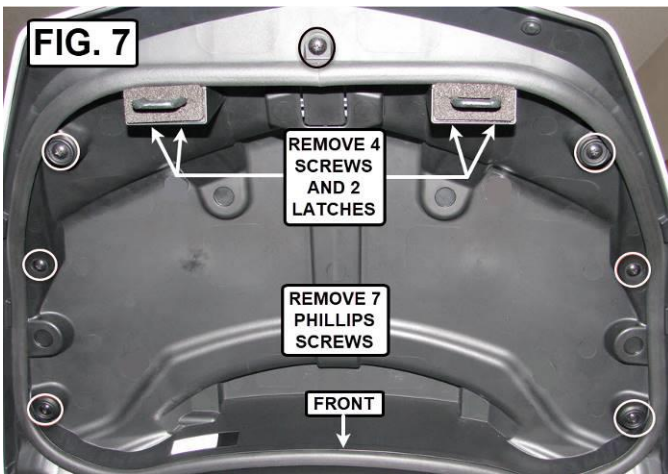
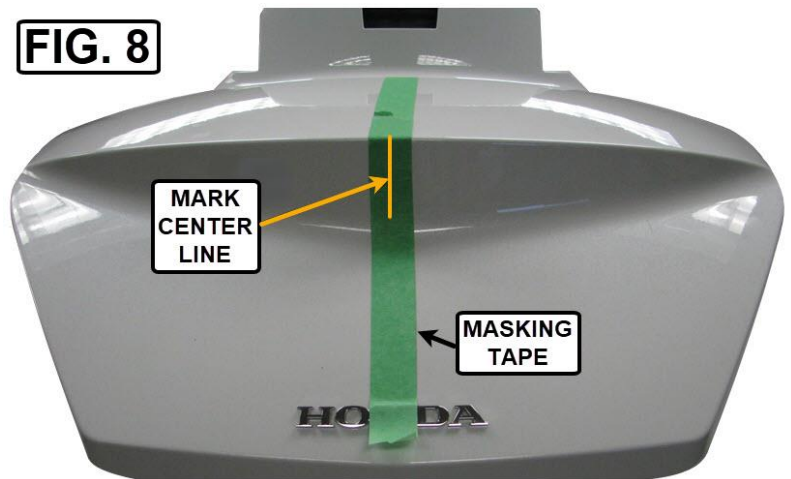
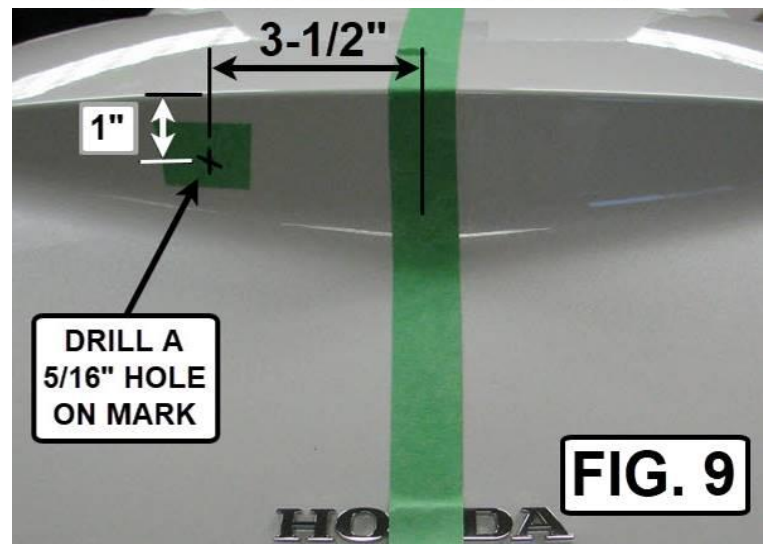
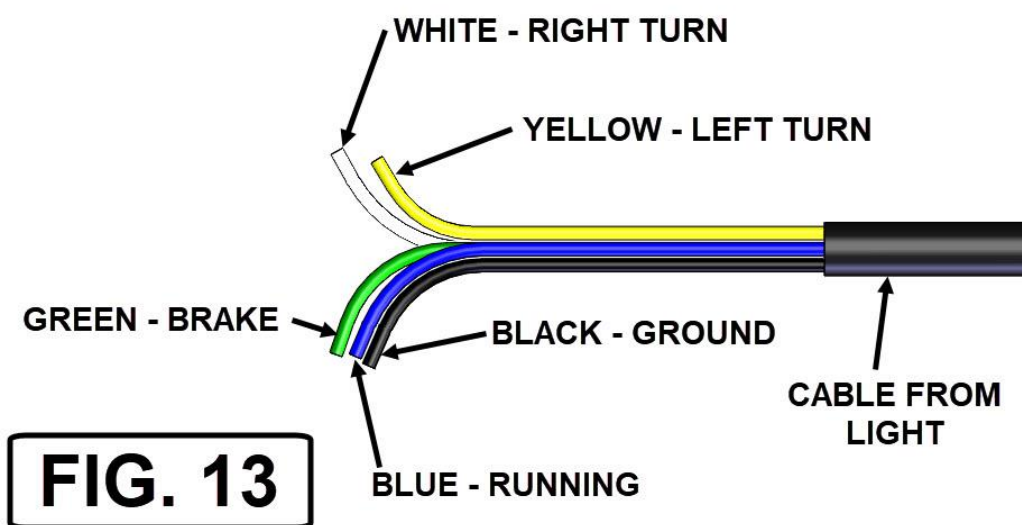
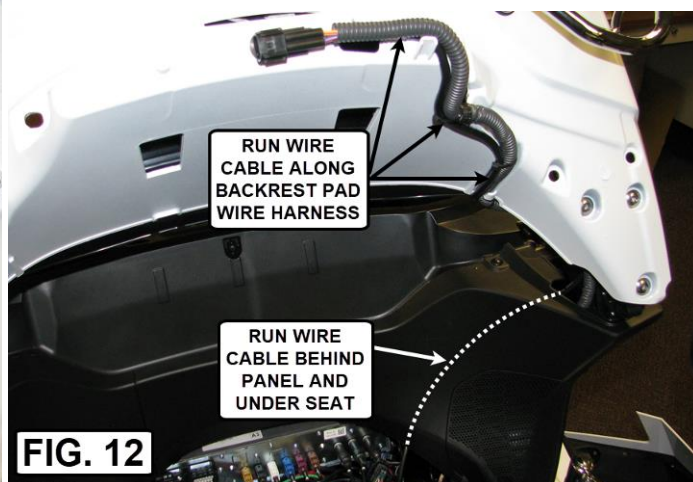
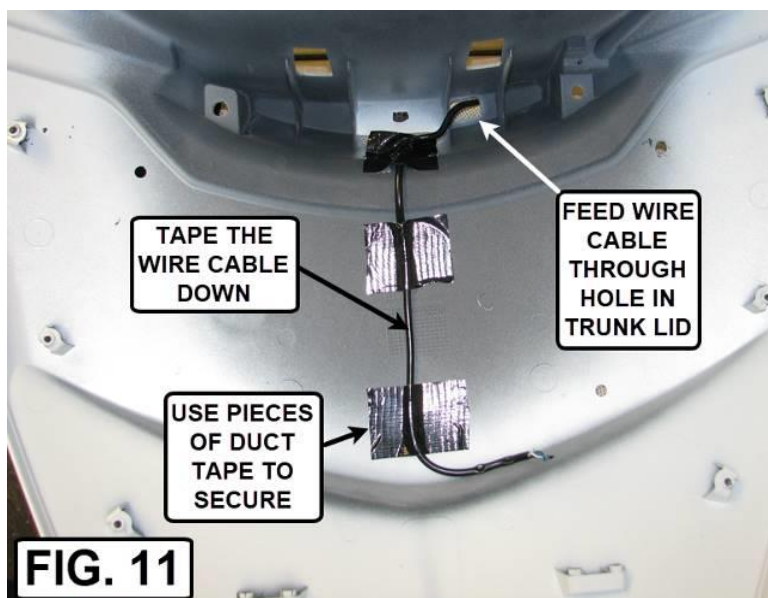
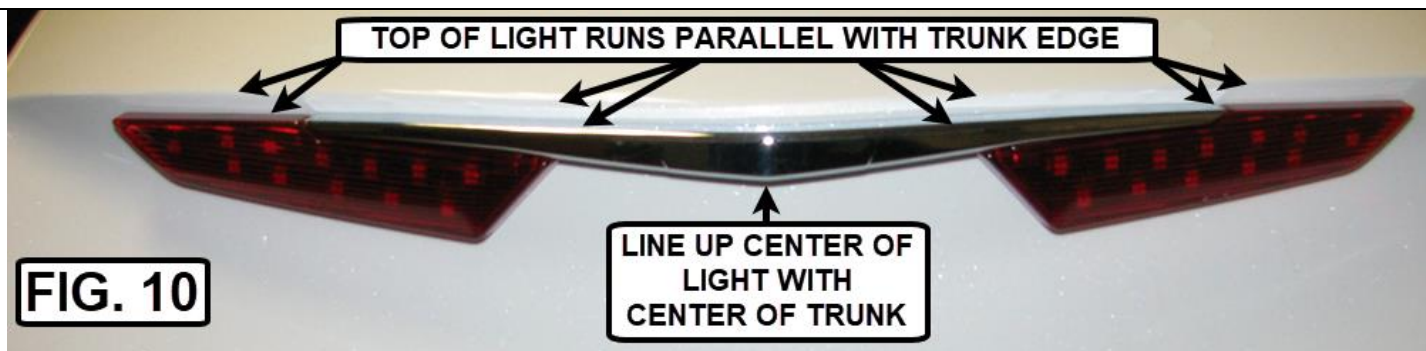

FIG. 4**FIG. 5****FIG. 6****FIG. 7****FIG. 8**

NOTICE

IGNORING THE CONTENTS OF THESE INSTRUCTIONS MAY AFFECT THE PRODUCT PERFORMANCE AND FUNCTIONALITY. NOT FOLLOWING THESE INSTRUCTION MAY CAUSE DAMAGE TO THE PRODUCT OR THE VEHICLE TO WHICH IT IS BEING ATTACHED.

**FIG. 9**



NOTICE

ADDING MULTIPLE ACCESSORIES TO A CIRCUIT MAY CAUSE ISSUES WITH SOME ACCESSORIES

NOTICE

BIG BIKE PARTS RECOMMENDS INSTALLING AN ISOLATION FUSE BLOCK (PART NUMBER 52-942) BEFORE CONNECTING ANY ADDED ELECTRICAL ACCESSORIES TO THE BIKE