



## PLUG AND PLAY TRAILER WIRING/RELAY GL 1800

## 7676

### PARTS INCLUDED

- 1 Plug and Play Trailer Wiring and Relay Harness
- 1 GL 1800 Trailer Wiring Sub Harness—4 Pin to 6 Pin
- 1 "Y" Adapter Harness—6 Pin Male to Two 6 Pin Female
- 1 Inline Fuse with "Y" Harness
- 1 Hardware Kit Containing:
  - 6 8" Black Nylon Cable Ties
  - 1 1/4" Ring Terminal
  - 1 Dielectric Grease Pack
  - 2 1" X 2" Adhesive Backed Hook Strap
  - 2 1" X 2" Adhesive Backed Loop Strap
  - 1 Alcohol Pad
- 1 Installation Instructions

Please read and understand entire instructions before starting installation.

### THANK YOU FOR CHOOSING KÜRYAKYN!

**IN ORDER TO PROTECT YOU AND OTHERS FROM POSSIBLE INJURY AND/OR PROPERTY DAMAGE OR LOSS, PLEASE PAY CLOSE ATTENTION TO ALL INSTRUCTIONS, WARNINGS, CAUTIONS AND ATTENTION NOTES REGARDING THE USE AND CARE OF THIS PRODUCT.**

**WARNING!** THIS INDICATION ALERTS YOU TO THE FACT THAT IGNORING THE CONTENTS DESCRIBED HEREIN CAN RESULT IN POTENTIAL DEATH OR SERIOUS INJURY.

**ATTENTION!** This indication alerts you to the fact that ignoring the contents described herein may negatively affect product performance and functionality.

**CAUTION!** This indication alerts you to the fact that ignoring the contents described herein can result in potential injury or material damage.

### TOOLS SUGGESTED

Set of Hex Wrenches, Combination Wrenches, Wire Stripper, Crimping Pliers, Side Cutters, Test Light or Multi-Meter

**STRICTLY OBSERVE THE FOLLOWING GUIDELINES IN ORDER TO USE THE PRODUCT PROPERLY AND AVOID POTENTIALLY DANGEROUS ACCIDENTS.**

**STEP 1** Read and understand all steps in the instructions before starting the installation. Park the motorcycle on a hard, level surface and turn off the ignition.

**NOTE:** This product requires the separate purchase and installation of Kuryakyn Part Number 3230, Rear Accessory Plug and Play Harness.

**NOTE:** This Harness requires the installer to hardwire the matching trailer plug connection or Kuryakyn Part Number 7659, Trailer Receptacle, purchased separately, to the relay harness.

### CUSTOMER SERVICE

877.370.3604 (toll free)

### INSTALLATION QUESTIONS

techsupport@kuryakyn.com  
or call 715.247.2983

### LIMITED WARRANTY

Kuryakyn warrants that any Kuryakyn products sold hereunder, shall be free of defects in materials and workmanship for a period of one (1) year from the date of purchase by the consumer excepting the following provisions:

- Kuryakyn shall have no obligation in the event the customer is unable to provide a receipt showing the date the customer purchased the product(s).
  - The product must be properly installed, maintained and operated under normal conditions.
  - Kuryakyn makes no warranty, expressed or implied, with respect to any gold plated products.
  - Kuryakyn shall not be liable for any consequential and incidental damages, including labor and paint, resulting from failure of a Kuryakyn product, failure to deliver, delay in delivery, delivery in nonconforming condition, or for any breach of contract or duty between Kuryakyn and a customer.
- Kuryakyn products are often intended for use in specific applications. Kuryakyn makes no warranty if a Kuryakyn product is used in applications other than intended.
- Kuryakyn electrical products are warranted for one (1) year from the date of purchase by the consumer. L.E.D.'S contained in components of Kuryakyn products will be warranted for defects in materials and workmanship for 3 years from the date of purchase where as all other components shall be warranted for one(1) year. This includes, but is not limited to; control modules, wiring, chrome & other components.

• Kuryakyn makes no warranty of any kind in regard to other manufacturer's products distributed by Kuryakyn. Kuryakyn will pass on all warranties made by the manufacturer and where possible, will expedite the claim on behalf of the customer, but ultimately, responsibility for disposition of the warranty claim lies with the manufacturer.

### ABOUT OUR CATALOG

For purchasing Kuryakyn® products, you can receive a complete catalog free of charge. Send the Proof-of-Purchase below with your address to: Kuryakyn, P.O. Box 339, Somerset, WI 54025. Please indicate either Accessories Catalog for Harley-Davidson® or GL & Metric Cruisers.

Be sure to ask your local dealer about other Kuryakyn® products, the motorcycle parts and accessories designed for riders by riders.

©2005 Kuryakyn USA® All Rights reserved.



- STEP 2** Remove four fasteners that secure the rear license plate panel. PIC 1.
- STEP 3** Remove the four mounting bolts from the passenger handles that secure the seat.
- STEP 4** Remove the seat and set aside.

**CAUTION!** Avoid potential electrical shock! Disconnect the battery before starting this procedure.

- STEP 5** Remove the battery cover located on the driver's left hand side just above the passenger floor board.

- STEP 6** Take a piece of wire or a straight coat hanger (to pull the wire through) and run it between the frame and saddlebag, above the battery until you can reach it from the back of the bike. The wire should come out to the top left of the inside back panel.

- STEP 7** With the supplied Trailer Isolation Relay Kit, take the red, red with a black stripe power wire and black ground wire. Tape them to the wire that was run in Step 6. Secure the wire tight enough that it will not come undone in the routing process.

- STEP 8** Pull the wire or coat hanger back toward the front with the wires still secured to it.

- STEP 9** Once the wires are pulled far enough to reach the battery, they can be removed from the wire/coat hanger.

- STEP 10** Take one of the butt connectors on the fuse holder "Y" wire and crimp it on the end of the red power wire that was run from the back of the bike. PIC 2 Take the supplied ring terminal and crimp it to the black ground wire. PIC 3

- STEP 11** The red wire with a black stripe is a power wire that can be used for keyless entry power or interior lighting on the trailer. If your trailer **DOES NOT** need an extra power wire for accessory lighting, then **DO NOT** connect this to the other "Y" wire from the fuse holder. Wrap the butt connector on the unused red "Y" wire with electrical tape or heat shrink to prevent an unwanted short, as it will have power to it all the time, and secure it out of harms way. Proceed to Step 13.

**WARNING:** WHEN THE SINGLE RED WIRE WITH THE RING TERMINAL IS CONNECTED TO THE BATTERY IN STEP 13, THE RED WIRE WITH THE BUTT CONNECTOR WILL HAVE POWER AT THE BUTT CONNECTOR. **MAKE SURE IT IS CAPPED OFF AS IN STEP 11 BEFORE ATTACHING THIS WIRE TO THE BATTERY!**

- STEP 12** If your trailer **DOES** need an extra power wire for accessory lighting, Take the red with black stripe power wire and connect it to the end of the second "Y" wire with the attached butt connector. PIC 8 Slide the wire into the end of the butt connector and crimp.

**NOTE:** If you would like to have "keyed" power to the red with black stripe wire, instead of constant power, use a test light to find a "keyed" wire on the bike and attach this wire to it. Be sure to cap off the unused butt connector on the "Y" wire from the fuse holder as in Step 11. Make sure that the added amperage from the trailer accessory will not overload the chosen circuit.

**WARNING:** WHEN THIS SINGLE RED WIRE WITH THE RING TERMINAL IS CONNECTED TO THE BATTERY IN STEP 15, THE RED WIRE WITH THE BLACK STRIPE WILL HAVE POWER AT THE OTHER END OF IT. **MAKE SURE IT IS CAPPED OFF AS THE RED WIRE IN STEP 13, OR ATTACHED TO THE TRAILER PLUG, BEFORE ATTACHING THIS WIRE TO THE BATTERY!**

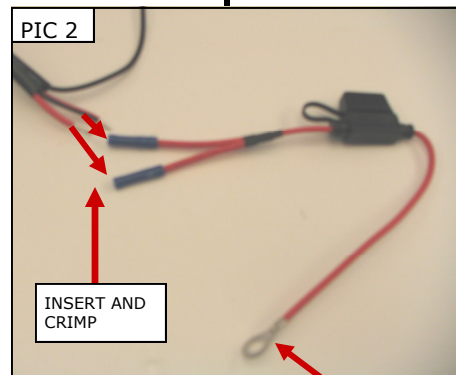
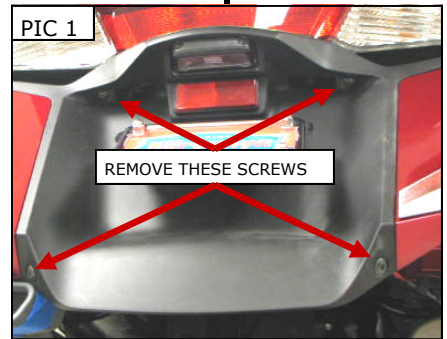

TO BATTERY POSITIVE REFER TO WARNING STEP 11 AND STEP 12 BEFORE CONNECTING

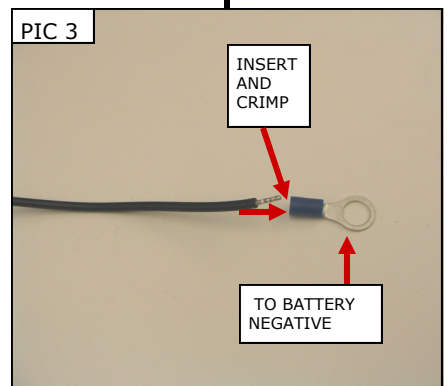

**STEP 13** Reconnect all wires that were attached to the positive side and the single red wire from the other end of the fuse holder with the ring terminal to the positive side of the battery. PIC 8 Reconnect all wires that were attached to the negative side and the long black ground wire to the negative on the battery.

**STEP 14** Locate the 6 Pin to 4 Pin Sub Harness. PIC 4 On the back of the bike, plug the four pin connector on the Trailer Isolation Relay into the four pin connector on the sub harness. PIC 5.

**NOTE:** The "Y" adapter is included to provide power for any additional Kuryakyn Accent Lighting on the rear of the motorcycle. If you do not have any additional Kuryakyn Lighting at this time, save the "Y" adapter for future use. PIC 4 and PIC 6

**STEP 15** Plug the 6 Pin connector of the Sub Harness or the 6 Pin connector on the "Y" adapter into the connector from the Rear Accessory Plug and Play Harness, P/N 3230. PIC 5 and PIC 6

**STEP 16** With the two (six pin) plugs connected, and the battery reconnected, use a test light to check for proper function. Turn the key on and test both signals. (Yellow is left turn and Green is right turn) Brake lights (Blue) and Run light (Brown). The white wire is ground.

**ATTENTION!** Secure all wiring away from any moving parts, pinch points or extreme heat. Kuryakyn WILL NOT issue a warranty on any electrical component that fails due to pinched, crimped, broken, abraded, melted or frayed wires.

**STEP 17** Use the included Hook and Loop Adhesive Strips to secure the Relay out of harms way. Tie up any excess wire length with the provided cable ties.

**STEP 18** Install your choice of trailer plug connector on the end of the wire harness from the Isolation Relay.

**STEP 19** Re-install seat and secure with the mounting hardware that was removed in Step 3. Put the rear panel back on and re-install the four mounting bolts.

**WARNING!** ENSURE PROPER TRAILER WIRING HARNESS AND RELAY OPERATION BEFORE RIDING THE MOTORCYCLE. VISIBILITY IS A MAJOR CONCERN FOR MOTORCYCLISTS. A TRAILER WIRING HARNESS AND RELAY MALFUNCTION COULD RESULT IN DEATH OR SERIOUS INJURY.

**ATTENTION!** It is the installer's responsibility to ensure that all of the fasteners (including pre-assembled) are tightened before operation of the motorcycle. Kuryakyn will not issue a warranty on components lost due to improper installation. Periodic maintenance may be required.

