

<b>INSTALLATION GUIDE</b>	ITEM / DESCRIPTION	PART NO.	MODEL
	<b>POWER ACCESSORY HUB (PROTECTED)</b>	<b>PAH60GW</b>	<b>GL1800 / 2018+</b>

Designed to safely connect your electronic accessories from a central location, the PAH60 (Power Accessory Hub) is a rugged weatherproof power distribution hub. Connect lighting such as running lights, third brake lights, or auxiliary equipment without worrying about lighting errors or canbus fault codes. The PAH60 connects to 12v power (battery).

## HARDWARE

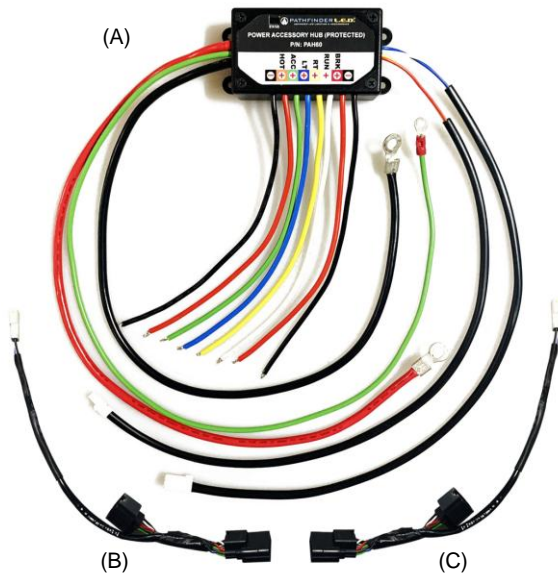

**STATUS LED = GREEN:** OPERATIONAL / **RED:** FAULT

	DESCRIPTION	QTY
A	Power accessory hub (protected)	1
B	Right PnP Adapter (w/ yellow wire)	1
C	Left PnP Adapter (w/ blue wire)	1
-	Installation Guide	1

### TOOLS REQUIRED

<ul style="list-style-type: none"> <li>▪ Phillips Screwdriver (P0, P2 / JIS)</li> <li>▪ Standard Screwdriver</li> <li>▪ Hex Wrench (6 mm)</li> <li>▪ Electrical Tape</li> <li>▪ Heat Gun</li> </ul>	<ul style="list-style-type: none"> <li>▪ Shrink Tube</li> <li>▪ Wire Ties</li> <li>▪ Double Sided Tape</li> <li>▪ Dual-Lock Fastener</li> <li>▪ Wire Stripper/Crimper</li> </ul>
---	--

### TIPS:

- ▶ Use wego or heatshrink tubing to cover any unused/exposed wiring to prevent damage.
- ▶ To reset PAH60, simply turn your motorcycle or ACC switch off for at least 5 seconds, then switch on.
- ▶ We highly recommend that you disconnect the PAH60 if winterizing/motorcycle won't be used for 2+ months.

### INSTALLATION NOTE:

**Prior to start, review entire installation video provided online by visiting the link below:**

- ▶ [socialmotogear.com/PAH60GWvideo](https://socialmotogear.com/PAH60GWvideo)



**If you need to view / re-print this guide:**

- ▶ [socialmotogear.com/PAH60GWmanual](https://socialmotogear.com/PAH60GWmanual)



**BEST PRACTICE:** When not riding your bike for three or more days, place your battery on a trickle charger/ battery tender, to both extend the life of the battery and support the small amount of power the PAH60 needs to keep "Always Hot" active when your bike is turned off.

### INSTALLATION PREP:

- Allow motorcycle (engine, radiator, exhaust, etc.) to cool down before performing installation.
- Place motorcycle on center stand.
- Disconnect the negative cable from the battery. Be aware that the memory, including clock and radio, will be lost when you disconnect the negative (-) cable.

### UPON COMPLETION OF INSTALLATION:

- Upon completion of installation, reconnect the battery and confirm that all functions on the PAH and motorcycle are working properly. Reset the clock and radio settings if needed. If an accessory is not working properly, disconnect the PAH from the battery before changing wiring connections.
- Tighten the screws, bolts and nuts securely. Refer to the Service Manual for the torque values of the removed parts.

1. Open the left saddlebag lid as shown.

- Repeat on the RIGHT side.

[LEFT side]

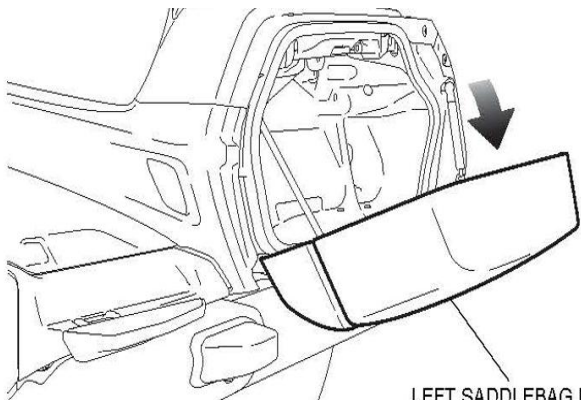

LEFT SADDLEBAG LID

2. Remove the left side cover as shown. Disconnect the negative (-) cable of the battery.

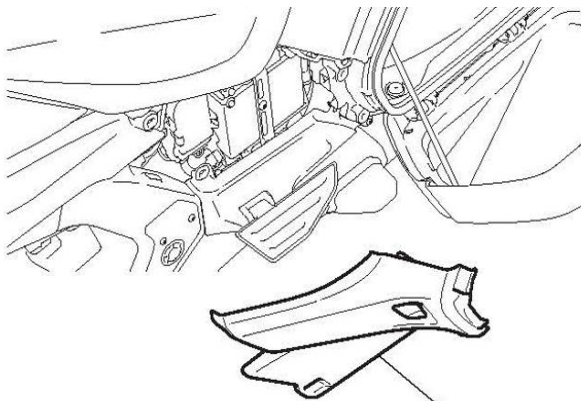

LEFT SIDE COVER

3. Remove the right side cover in the same manner as the left side.

4. Remove the seat as shown. Ensure seat heater connector is disconnected.

- Disconnect the connector for GL1800/D/DA.

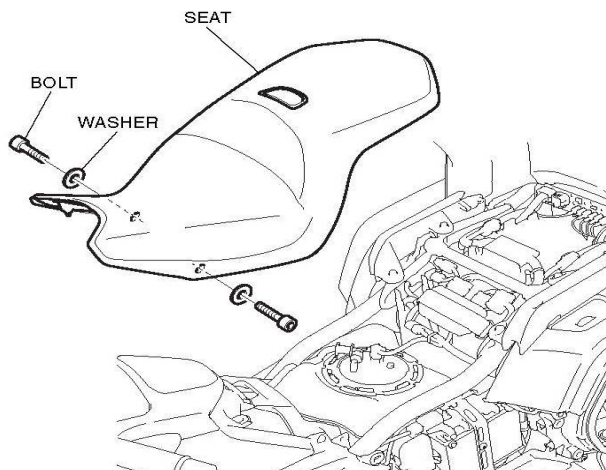

5. Place the power accessory hub at the area as shown in image below.



6. Locate the Right PnP White connectors as shown below.



7. On the PAH60, locate the white connectors on the right input sub-harness (w/ yellow wire). Connect the PAH60 right input sub-harness (w/ yellow wire) to the G184XP right output sub-harness as shown below.

- Repeat Steps 6 and 7 on the LEFT side (w/ BLUE WIRE).

[RIGHT side]



# INSTALLING ACCESSORIES

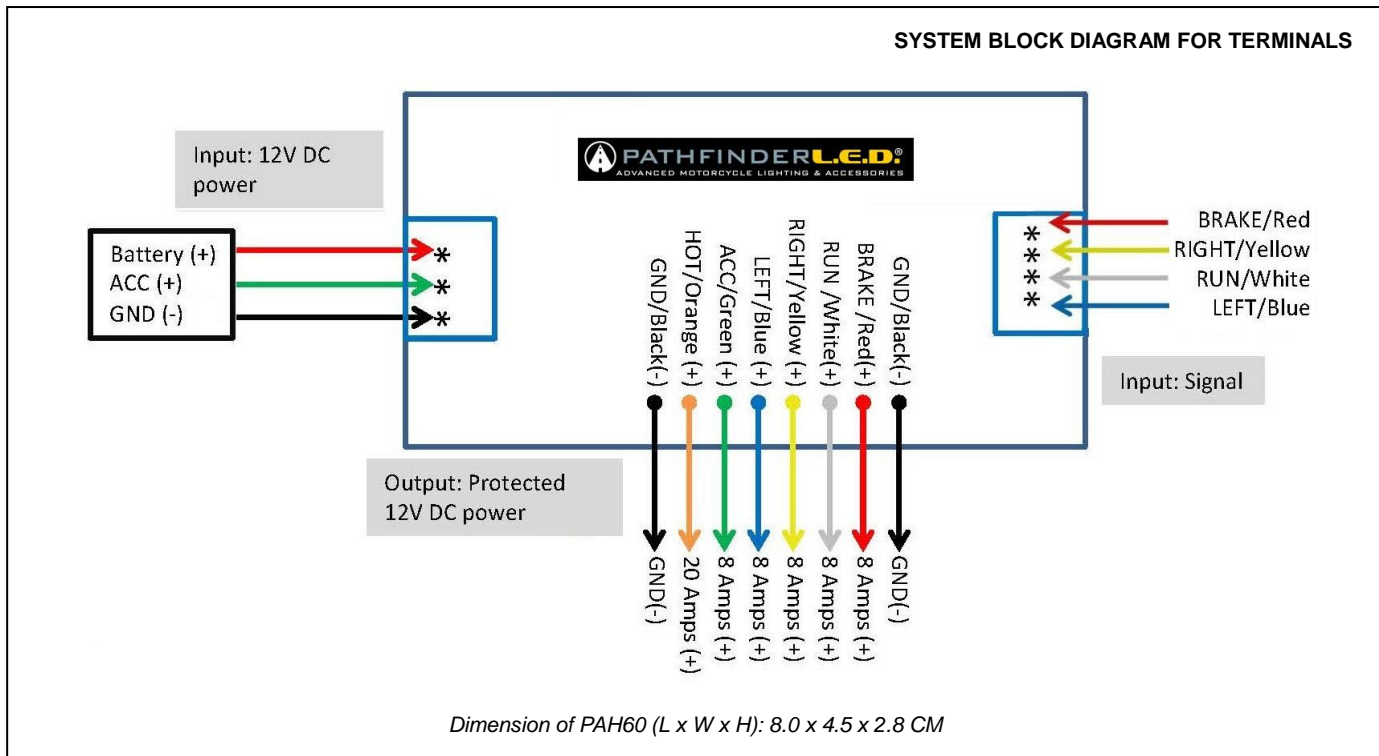

## SPECIFICATIONS:

- **Operating Range:** 9V-18V DC
- **Recommended:** 12V DC
- **Left Turn Signal:** 8A/96W
- **Right Turn Signal:** 8A/96W
- **Run (DRL):** 8A/96W
- **Brake Light:** 8A/96W
- **ACC:** 8A/96W
- **HOT:** 20A/240W

10. Connect the negative/ground wires from each accessory to either of the (-) ground wires on the PAH60. The negative ground wires are all common.
  - For multiple accessories, we recommend using the WEGO 222 connectors as shown below.



## FUSELESS DESIGN:

Each input and output is protected by advanced circuitry protection. To reset the unit, simply turn your ignition switch off for at least 5 seconds, then back on.

8. Install Accessories – Review the SYSTEM BLOCK DIAGRAM above.
9. Connect the positive wires from each accessory to the applicable (+) output wire on the PAH60.
  - For multiple accessories, we recommend using WEGO 222 connectors as shown.

**Pro tip:** Connect all left side accessories to one (-) ground wire and all right side accessories to the other (-) ground wire. Centerline accessories can connect to either (-) ground wire.

**IMPORTANT:** You must cap off the live wire and any other unused/exposed wires. Any wires left exposed may cause damage to your motorcycle.

11. Route the power wires (RED, GREEN, BLACK) as shown in the two images below. [Under the frame]

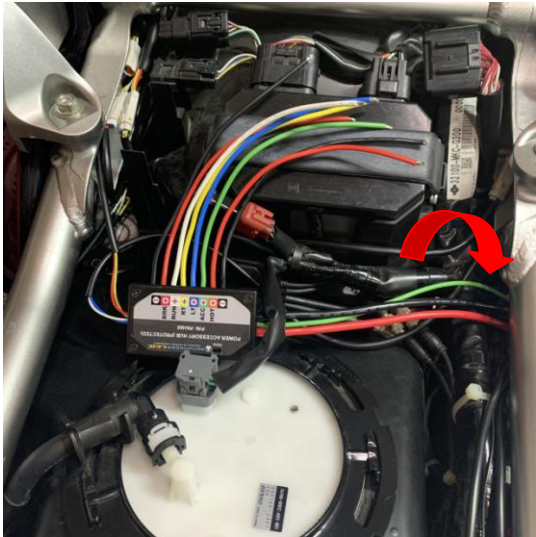
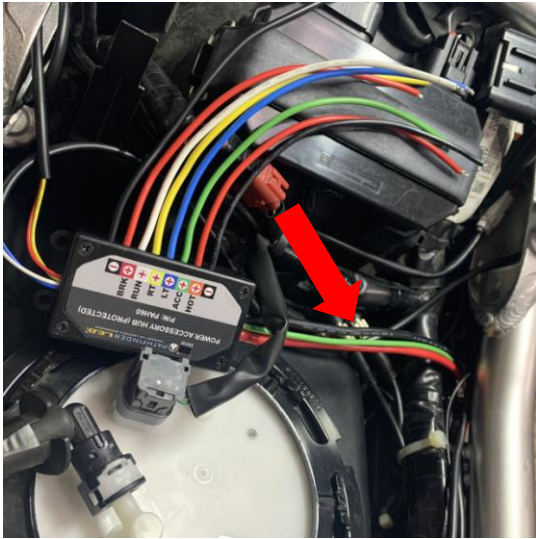

12. Connect the RED wire from the PAH60 to the positive (+) battery terminal as shown in image below.

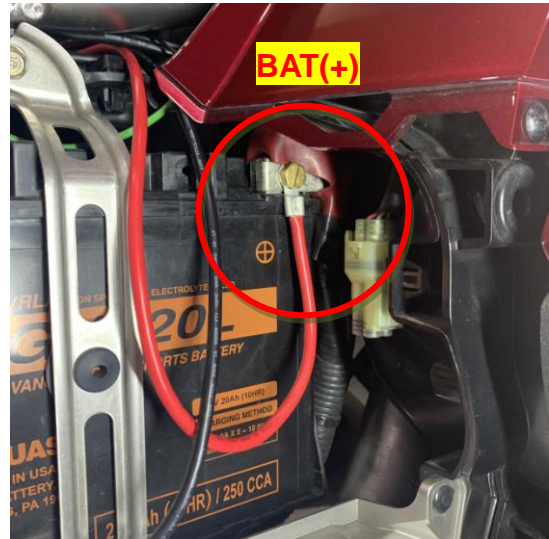

For Product Support, Email: service

13. Remove the fuse box cover. Connect the GREEN wire from the PAH60 to the positive (+) ACC terminal on the fuse box as shown in the image below. Reinstall fuse box cover.

Note: ACC screw can be very hard to loosen. If so, turn no more than 1/16<sup>th</sup> of turn clockwise (tighten) to attempt to break screw free.



14. Reconnect the motorcycle's negative cable that was disconnected in Step 2 to negative (-) battery terminal, then connect BLACK wire from the PAH60 to the negative (-) battery terminal as shown in image below.

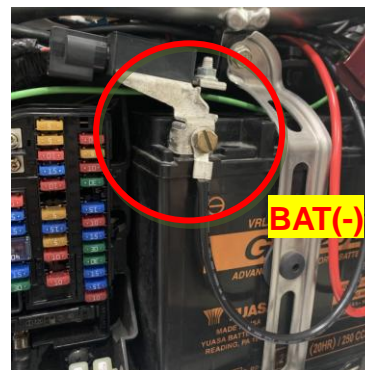

15. Check/test all motorcycle lights and accessories for proper operation. Fix any issues.

16. Check wiring and connectors:

- **Ensure that wire harness is not caught or too tight.**
- **Ensure that the seat will not crush the wires.**
- **After confirmation, use dual-lock fastener, double sided tape, or wire ties to secure the power accessory hub (PAH60).**

17. Reinstall motorcycle parts in the reverse order of removal.

*(seat, side covers, saddlebag lids)*

----- **INSTALLATION COMPLETE** -----