

Copyright© 2022 by Big Bike Parts, Inc. No part of this instruction sheet may be reproduced without the written permission of Big Bike Parts, Inc.

PART NO. 52-974/52-974BK

NON-FOLDING FLAG POLE

FITMENT: HONDA GOLD WING TOUR 2021-NEWER

12/2/2022

TOOLS NEEDED:	RUBBING ALCOHOL	CLEAN LINT FREE RAG	DRILL	1/4" DRILL BIT	4MM ALLEN WRENCH
	REMOVABLE THREAD LOCK	MASKING TAPE	PENCIL	5MM ALLEN WRENCH	

**PLEASE READ THROUGH AND UNDERSTAND THESE INSTRUCTIONS BEFORE BEGINNING. USE REMOVABLE THREAD LOCK WHEN INSTALLING ALL SCREWS.**  
**ESTIMATED INSTALLATION TIME: 20 TO 40 MIN.**

## INSTALLATION:

1. Open the trunk lid.
2. Starting on the right side of the bike, remove the five (5) screws shown in FIG. 1.
3. Remove the three (3) push pins shown in FIG. 1 by pressing the center in and pulling the push pin out.
4. Remove the push pin shown in FIG. 2 by pressing the center in and pulling the push pin out.
5. Remove the trunk side panel by sliding it straight back towards the rear of the bike and out. Set on a clean surface or towel.
6. Place a piece of masking tape on the trunk side panel as shown in FIG. 3.
7. Mark the location of the two holes according to FIG. 3. **Be sure hole locations marked are accurately placed before drilling.**
8. Using a 1/4" drill bit, drill two 1/4" holes on the marks from step 7 (FIG. 3) through the trunk side panel (BBP recommends using a brad point drill bit when drilling plastic to avoid damaging or breaking the plastic panels.)
9. Remove the masking tape and any burrs from drilling.
10. Remove the flag pole components from the packaging.
11. Use rubbing alcohol and a clean lint free rag to clean the outside surface of the trunk where the flag pole mount will be installed.
12. From the inside of the trunk side panel, place the flat bracket in position using the two supplied M6-1.0 x 16MM screws (FIG. 4).
13. Carefully apply a small drop of removable thread lock to each threaded hole on the flag pole mount. *Be sure thread lock does not come in contact with the plastic panels or damage may occur.*
14. Remove the backer from the double sided tape on the flag pole mount (FIG. 5). **(Be sure not to touch the adhesive on the double sided tape before installing the flag pole mount in place)**
15. Carefully start the two screws from step 9 in the flag pole mount (FIG. 5) to position the mount with the countersink on the bottom side. **(Do not let double sided tape touch the trunk yet)**
16. With both screws started in the flag pole mount, press the mount firmly in place against the trunk.
17. Tighten the two screws to secure. (do not over tighten screws or the plastic panels may crack or break.)
18. Remove O-ring from the flag pole and install the flag onto the flag pole by sliding it up from the bottom (FIG. 6).
19. Reinstall the O-ring onto the flag pole to keep the flag in position at the top of the flag pole (FIG. 6).
20. Install the flag pole on the flag pole mount using the M6-1.0 x 16mm long screw and two M6 flat washers (FIG. 6). *Use removable thread lock when installing the M6-1.0 x 16MM long screw. (Ensure all remaining hardware is secure. If any hardware becomes loose, additional thread locker may be applied.)*
21. Repeat steps on left side if installing 2 flag poles.

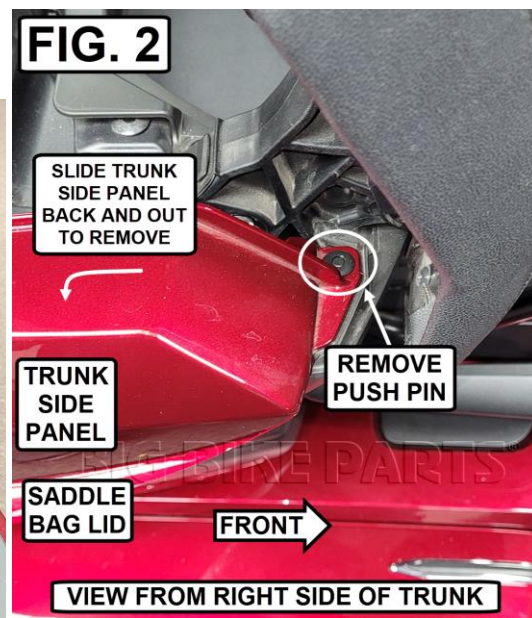
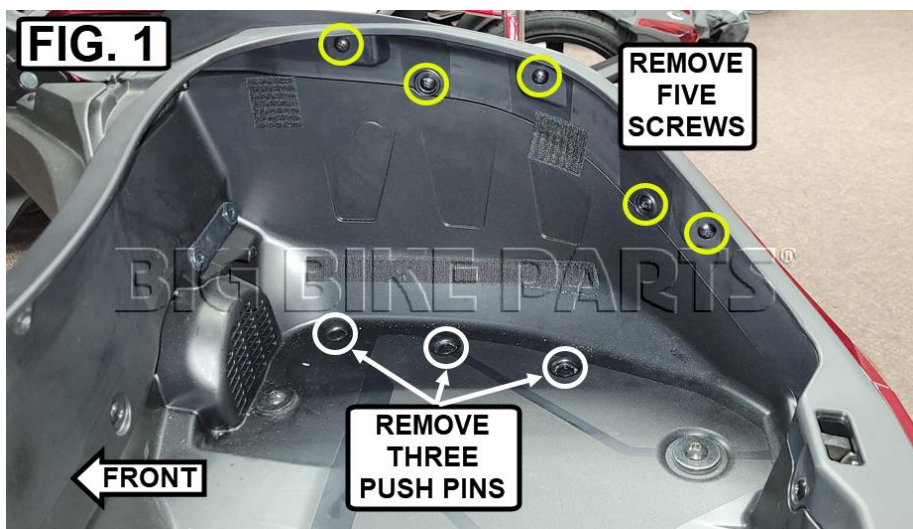

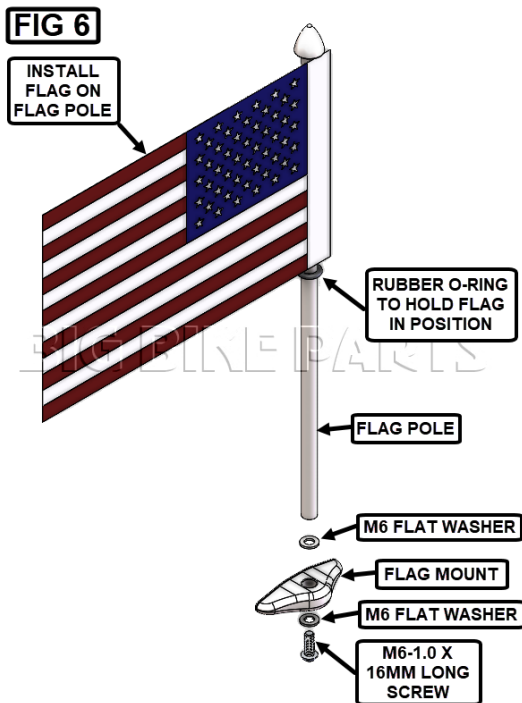
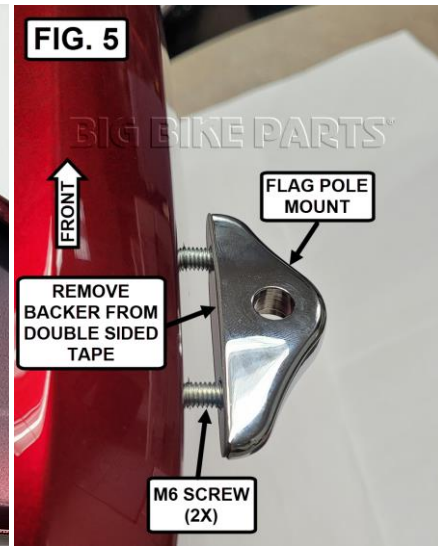
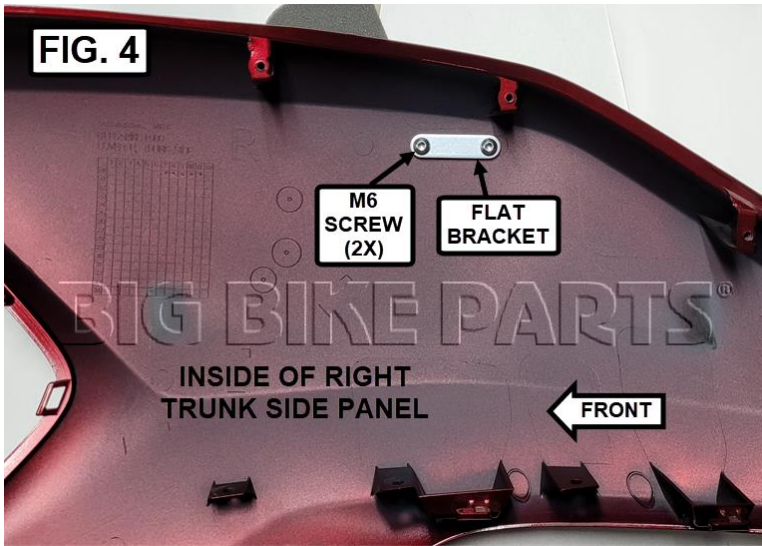

**NOTICE**

THIS IS AN ADHESIVE BACKED PRODUCT. CAUTION MUST BE TAKEN DURING INSTALLATION TO PROPERLY POSITION FOR ONE TIME PLACEMENT. REPEAT TRIALS WILL RESULT IN FAILURE OF THE ADHESIVE.

**NOTICE**

IGNORING THE CONTENTS OF THESE INSTRUCTIONS MAY AFFECT THE PRODUCT PERFORMANCE AND FUNCTIONALITY. NOT FOLLOWING THESE INSTRUCTION MAY CAUSE DAMAGE TO THE PRODUCT OR THE VEHICLE TO WHICH IT IS BEING ATTACHED.

**WARNING**

THREADLOCK CAUSES PLASTICS TO CRACK, BREAK OR BECOME BRITTLE. WHEN USING THREADLOCK TO INSTALL HARDWARE WITH PLASTIC COMPONENTS, ONLY APPLY TO METAL COMPONENTS. IT IS CRITICAL THAT ANY EXCESS THREADLOCKER OR SPILLAGE IS CLEANED COMPLETELY FROM PLASTIC COMPONENTS IMMEDIATELY BEFORE DRYING. A DAMP TOWEL OR RAG IS THE BEST WAY TO ACHIEVE THIS. IF EXCESS THREADLOCKER IS NOT CLEANED UP RIGHT AWAY, IT COULD LEAD TO DAMAGED PRODUCTS AND VOID WARRANTY.